

NEW\_Gmate Origin\_Quick  
guide\_CE\_0197

품번 : PM310-CE0-2205  
 사이즈 : 480 x 90 mm  
 접지 후 사이즈 : 60 x 90 mm  
 총 4도  
 8단  
 병풍접지 (점선 삭제)  
 재질 : 아트지 150  
 코팅 : 있음

2020.02.17  
 작성 : 홍종민

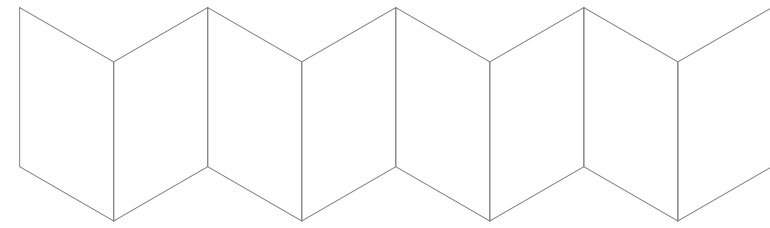

REF PG310-INT PM310-CE0-2205

# Quick Guide

## Gmate® Origin





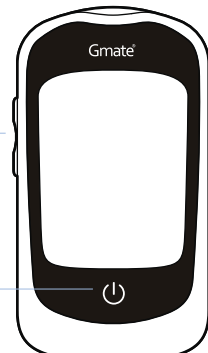

Side Buttons(Up/Down Button) are used to recall the stored results and adjust the parameters in setting mode.

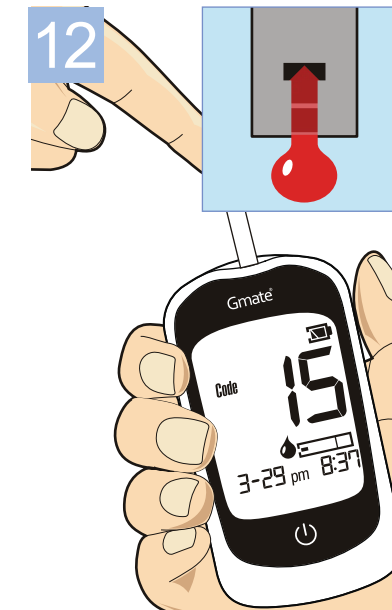
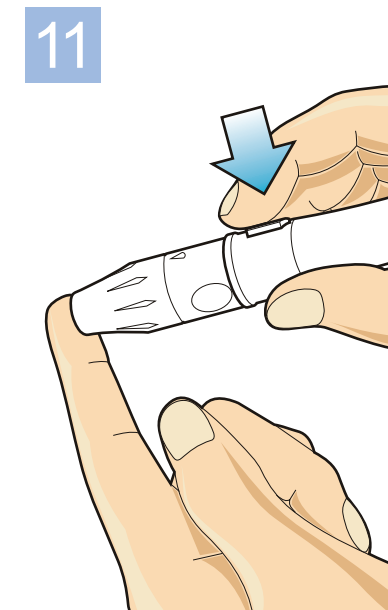
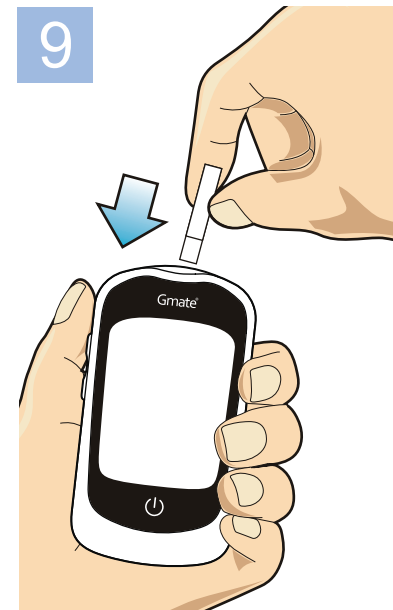
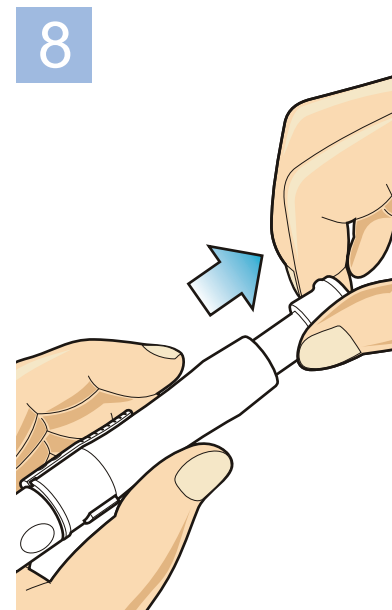
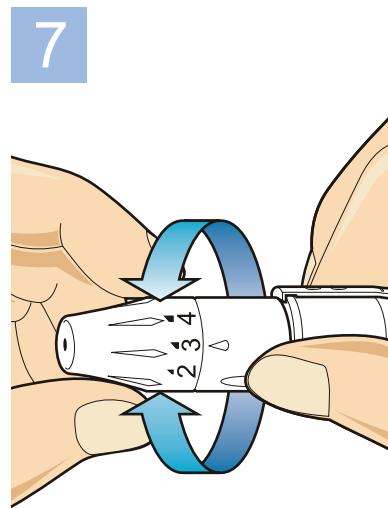
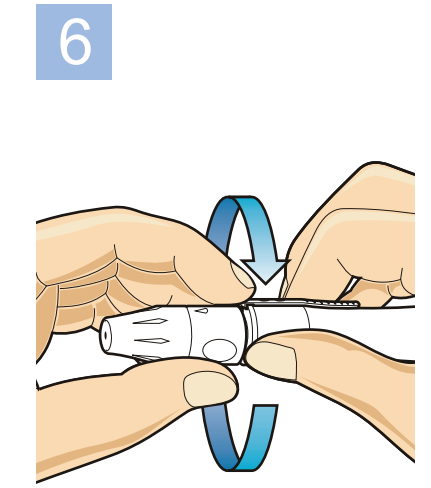
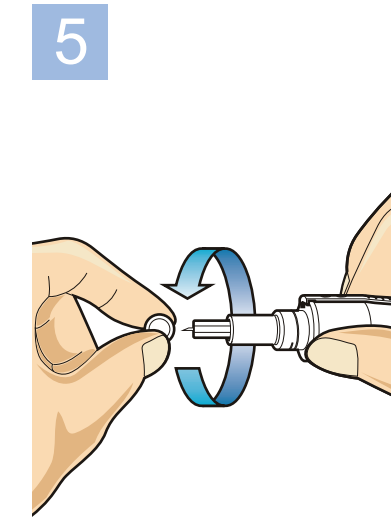
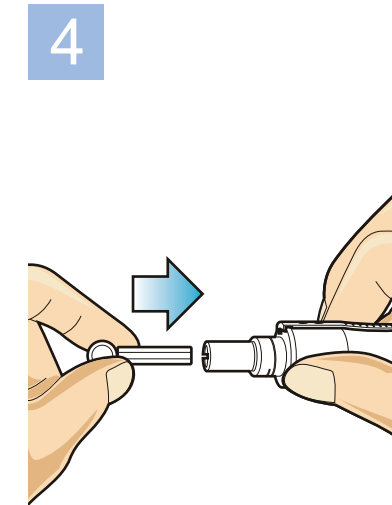
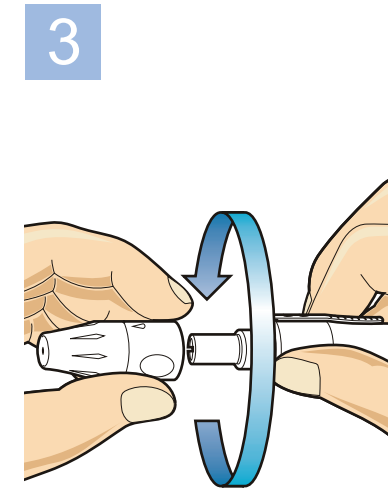
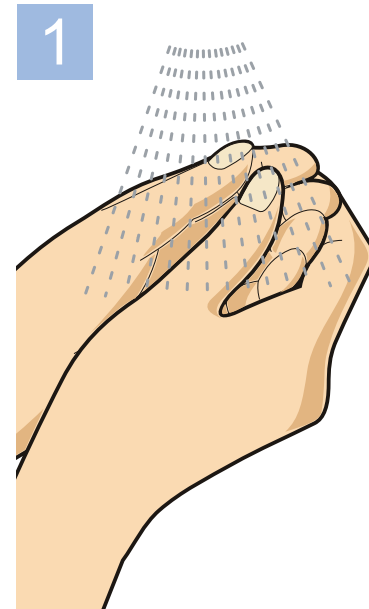

Power Button is used to meter on/off and change the meter modes.



-  E01 When inserting a used test strip.
-  E02 When the test strip may be inserted incorrectly or have a problem.
-  E03 When the meter has problem.
-  E04 When environmental temperature is BELOW or ABOVE system operation range. (10~32°C)
-  E05 Error message that may appear during your blood glucose testing. Please check "Testing Your Blood Glucose" page in the User's Guide and repeat the test with a new strip.